

Site Address: 638, Rayleigh Road, Hutton, Brentwood, Essex, CM13 1SJ

This plan is not provide at a recognised scale. Approximate dimensional figures for separate lengths of the site boundary are indicated. The total site area is approximately 0.6 HA.

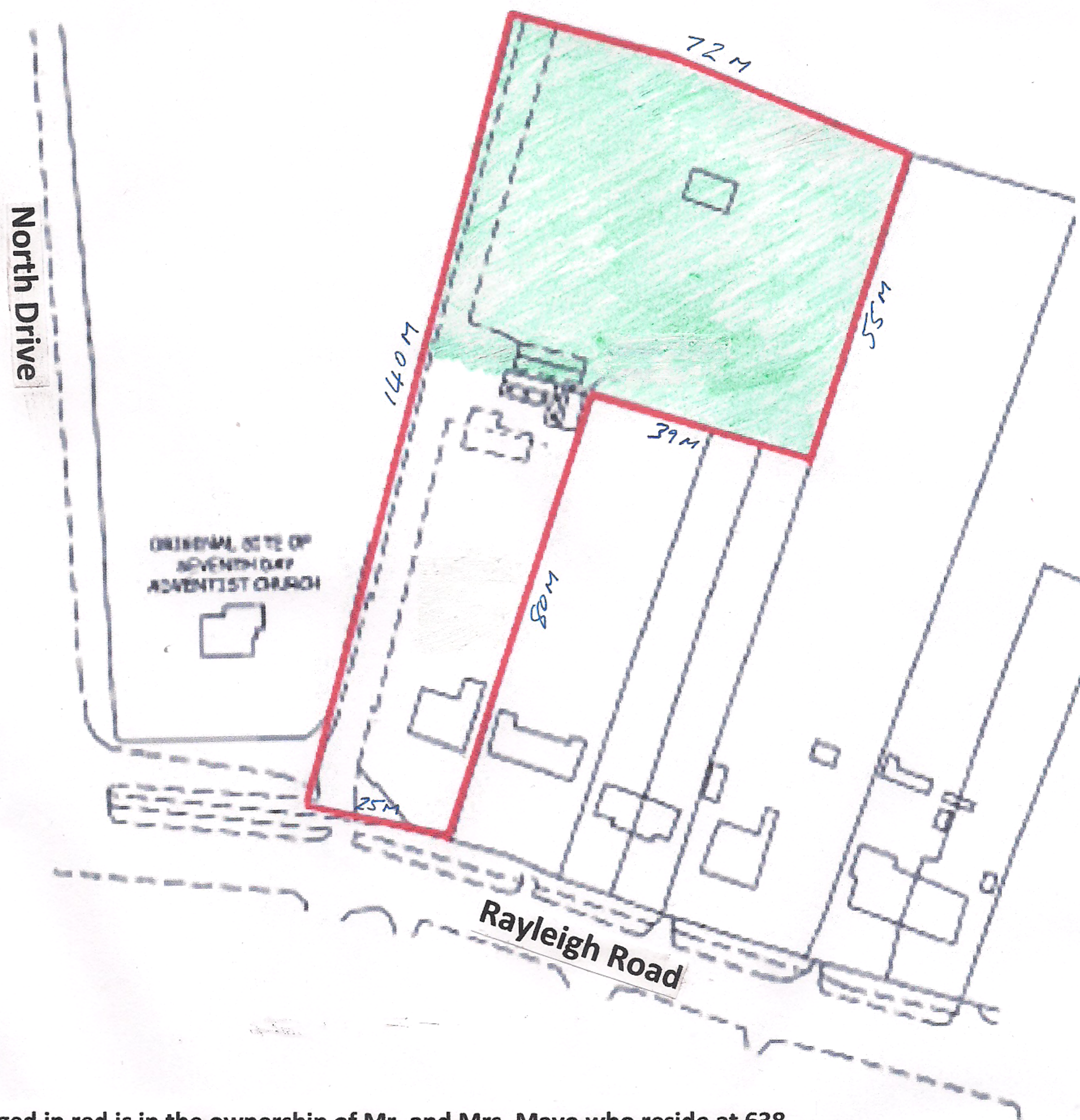

The entire site edged in red is in the ownership of Mr. and Mrs. Mayo who reside at 638 Rayleigh Road. In planning terms the unshaded area is 'developed' and has lawful residential use. The area shaded in green is an undeveloped field. The whole site is being put forward for consideration for inclusion as a residential development site in the emerging Local Development Plan, possibly as part of a new settlement boundary to be drawn around the wider Havering's Grove enclave.

LOCATION PLAN

