

NOTES
 The Contractor is to check all dimensions and conditions on site before commencing. Do not scale from this drawing.
 This drawing remains the copyright of POZZONI LLP.

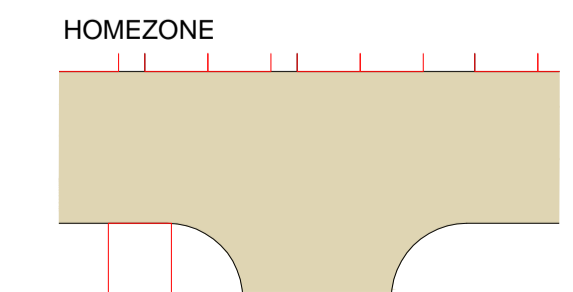

LEGEND:

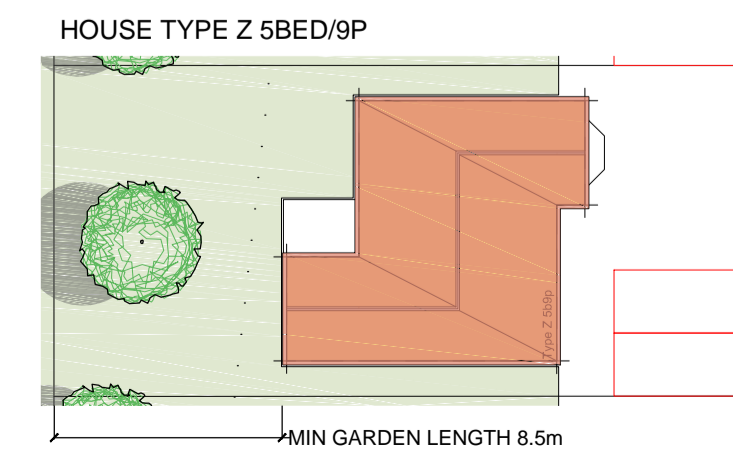
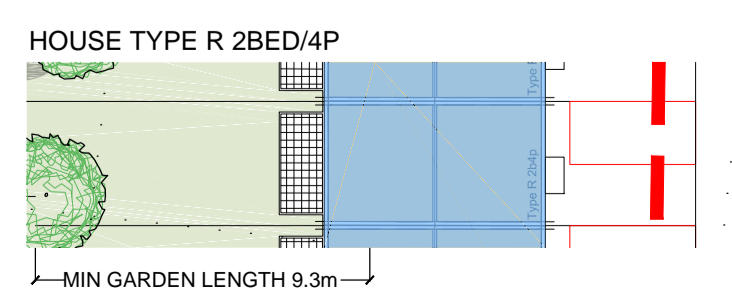
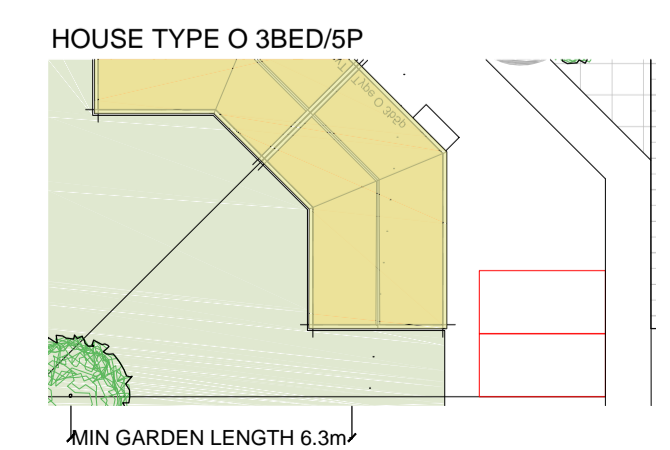
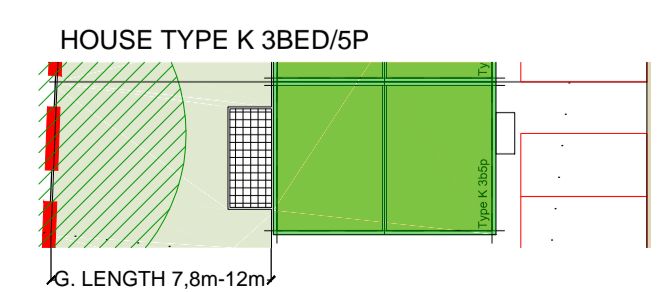
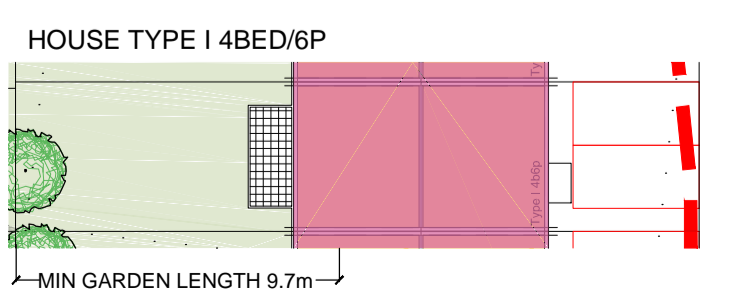

| Rev | Description | By | Date |
|-----|-------------|----|------|
| | | | |

Client
Hermes Investment Management

Job
West Horndon

Drawing
Masterplan Option 8 Extended

| | | |
|---------------------------------------|------------|-------------|
| <input type="checkbox"/> Feasibility | Scale | 1:1000@A1 |
| <input type="checkbox"/> Design | Sheet | JL |
| <input type="checkbox"/> Tender | Checked | |
| <input type="checkbox"/> Contract | Issue Date | March 16 |
| <input type="checkbox"/> Construction | Drg. No. | 50194 PL_01 |
| <input type="checkbox"/> As Built | | |



T 020 7078 0079
 E architects@pozzoni.co.uk
 1st Floor London House
 115 Golden Lane
 London
 EC1Y 0TJ